



**VISION Slide System**  
Follows Vision in Sliding  
Systems

**TECHNICAL**



WINDOW & DOOR SYSTEMS



VORNE VISION SLIDE Systems, are designed to create new horizons in sliding systems . Thanks to the smooth sliding motion is providing superior user pleasure. It provides excellent sound and heat insulation in all living spaces through its patented smart locking points.

- \* Easy operation
- \* Easy Assembly
- \* High Performance Insulation
- \* Extra Safety
- \* Less Maintenance
- \* 200kg
- \* 600mm - 2100mm width
- \* 450mm - 2400mm height
- \* 8 mm opening distance
- \* Ventilation function

VORNE VISION SLIDE SYSTEM's colour applications; White (RAL 9016), Silver, Black (RAL 9005), Grey Anthracite (RAL 7016) are in our stock. Also for special projects, it can be produced in all RAL colors.

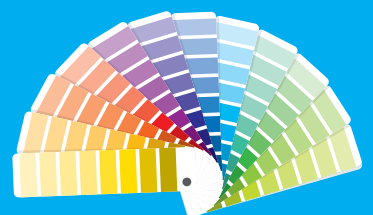
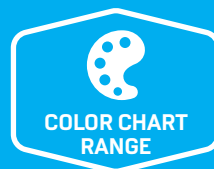

## Profile Information

Working position of the sash inside

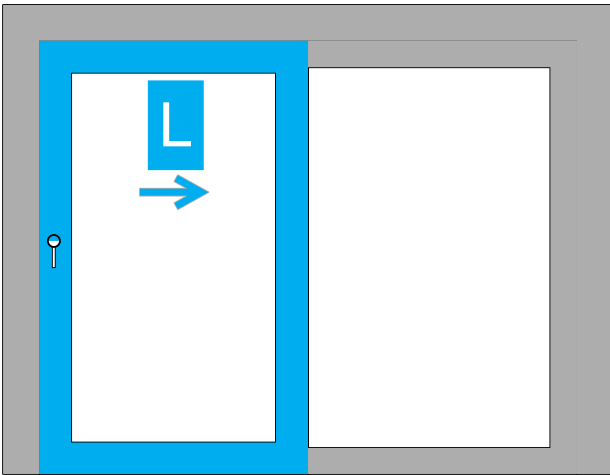

Working position with the sash out

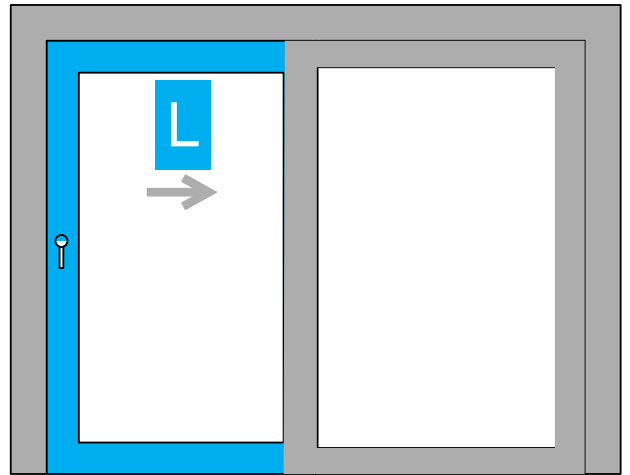

L Sliding Sash (Right or Left)  
1 Fixed Window

L Sliding Sash (Right or Left)  
1 Fixed Window

## Sash Profile

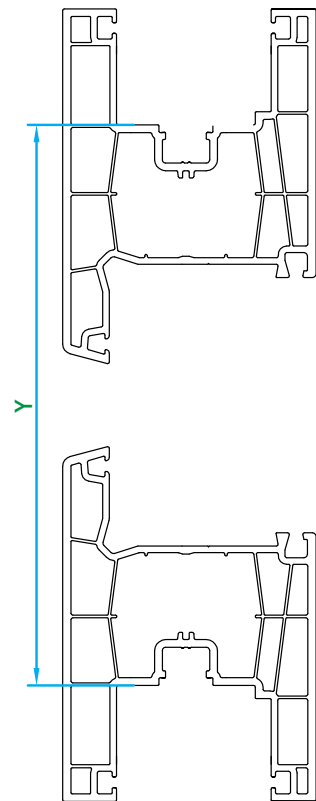
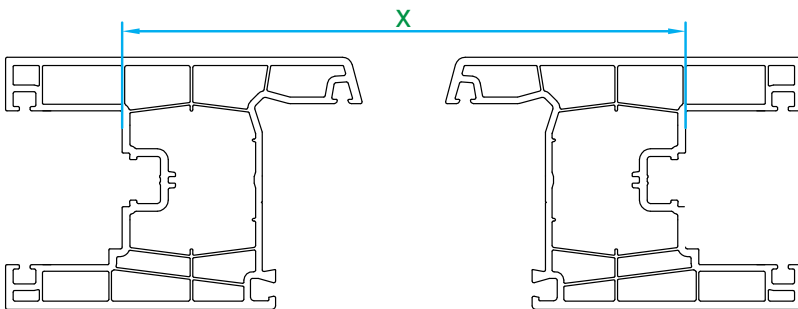
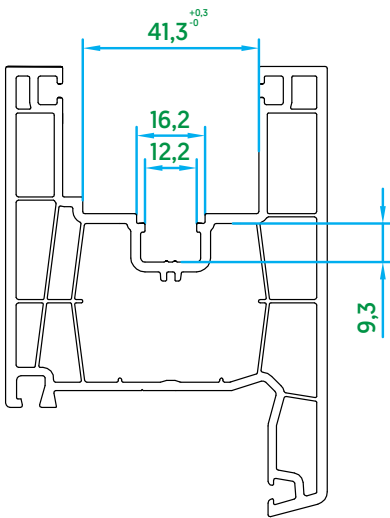

X = Sash Width Dimension  
Y = Sash Length Measurement

# System Chart

## Vision Slide System Chart

|     |                                  |
|-----|----------------------------------|
| 1   | Gear                             |
| 2   | Corner Slider                    |
| 2a  | Security Corner Slider           |
| 32  | Connection Gear                  |
| 30h | Handle                           |
| 35  | Extension Part                   |
| 102 | Guide Unit L/R                   |
| 103 | Center Locking L/R               |
| 104 | Center Locking Striker           |
| 105 | Center Locking Striker Cover Cap |
| 106 | Locking Pin                      |
| 107 | Bogie Unit L/R                   |
| 108 | Striker                          |
| 109 | Ventilation Striker              |
| 110 | Stopper                          |

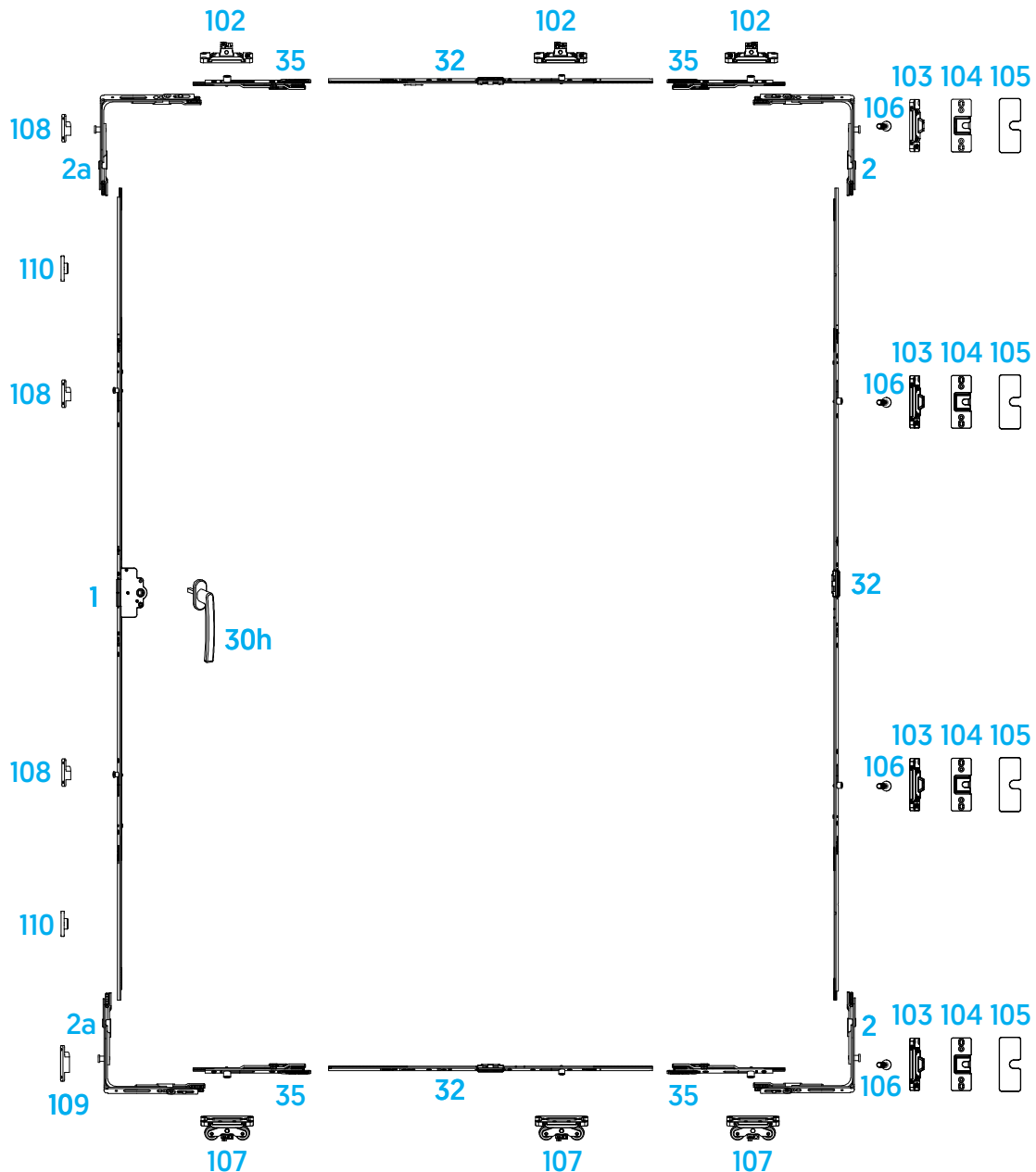

# Set Contents

## Set Contents 1000/L (V.4750.1L01)

| No  | Article                            | Article Code | Qty |
|-----|------------------------------------|--------------|-----|
| 2   | Corner Slider / 150 RC1 x 130 (mm) | V.0601.0102  | 2   |
| 2a  | Corner Slider / 150 SC1 x 130 (mm) | V.0601.0202  | 2   |
| 35  | Extension Part                     | V.1102.0102  | 4   |
| 102 | Guide Unit L                       | V.4752.0L02  | 2   |
| 103 | Center Locking L                   | V.4753.0L02  | 3   |
| 104 | Center Locking Striker             | V.4762.0102  | 3   |
| 107 | Bogie Unit L                       | V.4751.1L02  | 2   |
| 108 | Striker                            | V.4761.0102  | 2   |
| 109 | Ventilation Striker                | V.4761.0202  | 1   |
| 110 | Stopper                            | V.4764.0116  | 2   |



## Set Contents 1000/R (V.4750.1R01)

| No  | Article                            | Article Code | Qty |
|-----|------------------------------------|--------------|-----|
| 2   | Corner Slider / 150 RC1 x 130 (mm) | V.0601.0102  | 2   |
| 2a  | Corner Slider / 150 SC1 x 130 (mm) | V.0601.0202  | 2   |
| 35  | Extension Part                     | V.1102.0102  | 4   |
| 102 | Guide Unit R                       | V.4752.0R02  | 2   |
| 103 | Center Locking R                   | V.4753.0R02  | 3   |
| 104 | Center Locking Striker             | V.4762.0102  | 3   |
| 107 | Bogie Unit R                       | V.4751.1R02  | 2   |
| 108 | Striker                            | V.4761.0102  | 2   |
| 109 | Ventilation Striker                | V.4761.0202  | 1   |
| 110 | Stopper                            | V.4764.0116  | 2   |

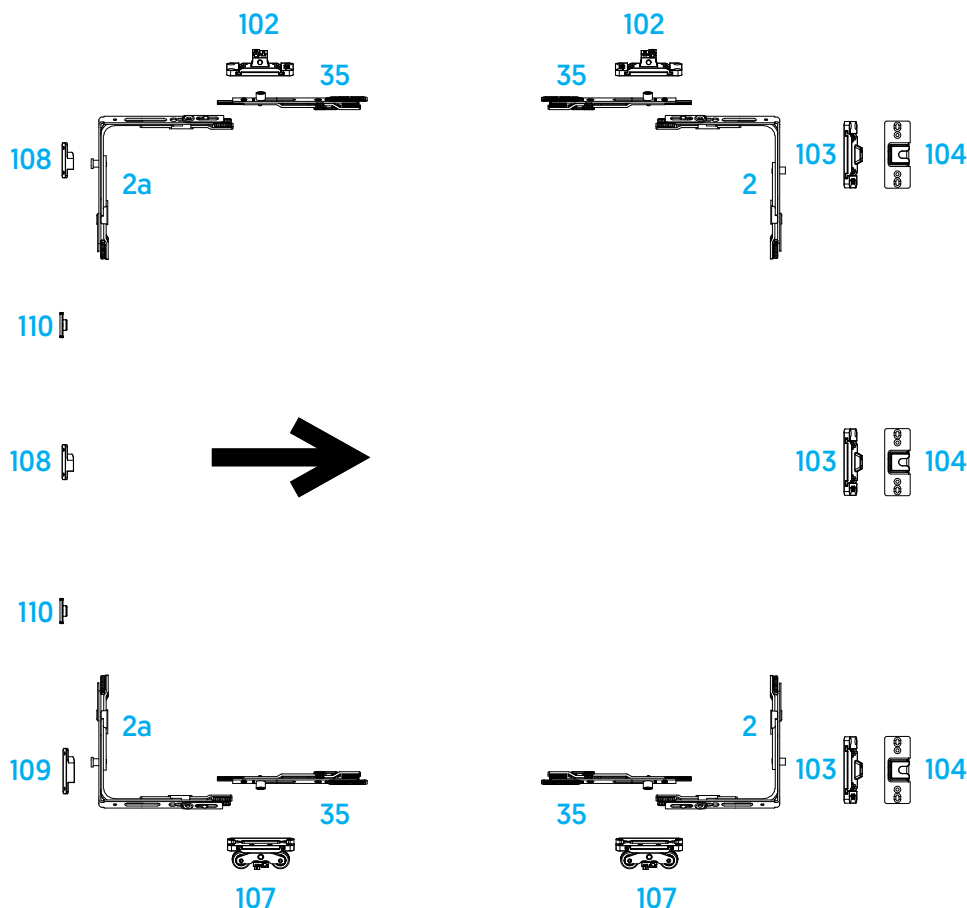

| Profile Name         | Set Code    |
|----------------------|-------------|
| Adopen               | V.4750.1x01 |
| Aluplast Smart Slide | V.4750.1x01 |
| Asaş Inowa           | V.4750.1x01 |
| Decco                | V.4750.1x01 |
| Gealan SMOOVIO       | V.4750.1x01 |
| Rehau Inowa          | V.4750.1x01 |
| Rehau Synego         | V.4750.1x01 |
| Schuco Inowa         | V.4750.1x01 |
| Tecnocom             | V.4750.1x01 |
| Veka E-Slide         | V.4750.1x01 |

# Set Contents

## Set Contents 2000/L (V.4750.2L01)

| No  | Article                            | Article Code | Qty |
|-----|------------------------------------|--------------|-----|
| 2   | Corner Slider / 150 RC1 x 130 (mm) | V.0601.0102  | 2   |
| 2a  | Corner Slider / 150 SC1 x 130 (mm) | V.0601.0202  | 2   |
| 35  | Extension Part                     | V.1102.0102  | 4   |
| 102 | Guide Unit L                       | V.4752.0L02  | 2   |
| 103 | Center Locking L                   | V.4753.0L02  | 3   |
| 104 | Center Locking Striker             | V.4762.0102  | 3   |
| 107 | Bogie Unit L                       | V.4751.2L02  | 2   |
| 108 | Striker                            | V.4761.0102  | 2   |
| 109 | Ventilation Striker                | V.4761.0202  | 1   |
| 110 | Stopper                            | V.4764.0116  | 2   |

## Set Contents 2000/R (V.4750.2R01)

| No  | Article                            | Article Code | Qty |
|-----|------------------------------------|--------------|-----|
| 2   | Corner Slider / 150 RC1 x 130 (mm) | V.0601.0102  | 2   |
| 2a  | Corner Slider / 150 SC1 x 130 (mm) | V.0601.0202  | 2   |
| 35  | Extension Part                     | V.1102.0102  | 4   |
| 102 | Guide Unit R                       | V.4752.0L02  | 2   |
| 103 | Center Locking R                   | V.4753.0L02  | 3   |
| 104 | Center Locking Striker             | V.4762.0102  | 3   |
| 107 | Bogie Unit R                       | V.4751.2R02  | 2   |
| 108 | Striker                            | V.4761.0102  | 2   |
| 109 | Ventilation Striker                | V.4761.0202  | 1   |
| 110 | Stopper                            | V.4764.0116  | 2   |

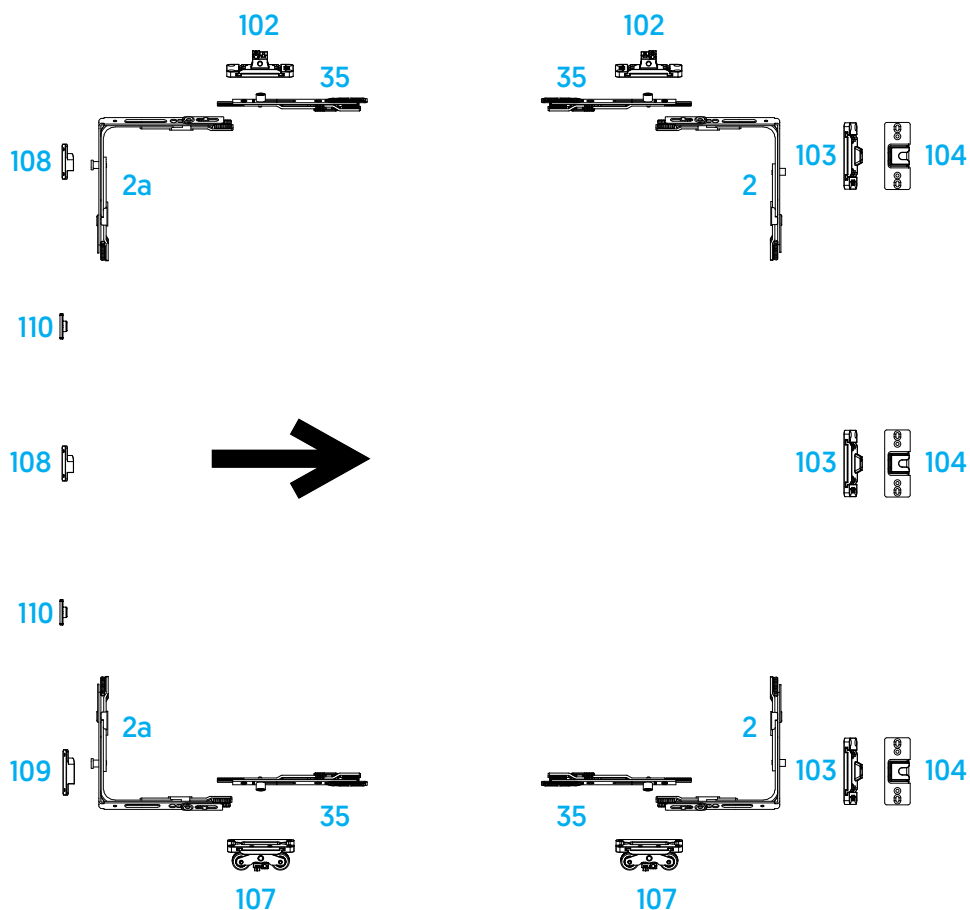

| Profile Name | Set Code    |
|--------------|-------------|
| Deceuninck   | V.4750.2x01 |
| Pimapen      | V.4750.2x01 |
| Salamander   | V.4750.2x01 |
| Schönline    | V.4750.2x01 |
| Winsa        | V.4750.2x01 |

## Bogie Unit L/R



|   | Article Code | Article         | Qty |
|---|--------------|-----------------|-----|
| A | V.4751.1X02  | Bogie Unit 1L/R | 3   |
| B | V.4751.2X02  | Bogie Unit 2L/R | 3   |

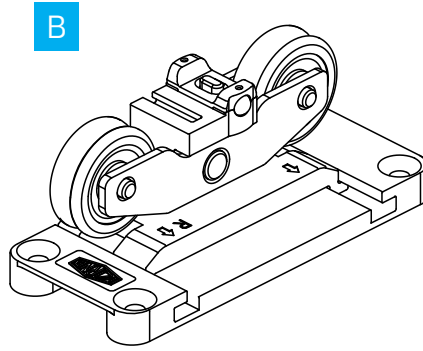
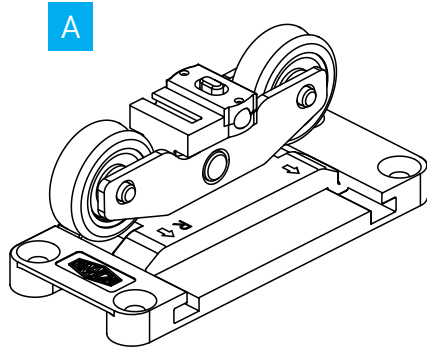

| Profile Name         | Supporter Slider Roller |
|----------------------|-------------------------|
| Adopen               | V.4751.1x02             |
| Aluplast Smart Slide | V.4751.1x02             |
| Asaş Inowa           | V.4751.1x02             |
| Decco                | V.4751.1x02             |
| Deceuninck           | V.4751.2x02             |
| Gealan SMOOVIO       | V.4751.1x02             |
| Pimapen              | V.4751.2x02             |
| Rehau Inowa          | V.4751.1x02             |
| Rehau Synego         | V.4751.1x02             |
| Salamander           | V.4751.2x02             |
| Schönlne             | V.4751.2x02             |
| Schuco Inowa         | V.4751.1x02             |
| Tecnocom             | V.4751.1x02             |
| Veka E-Slide         | V.4751.1x02             |
| Winsa                | V.4751.2x02             |

| Width Dimensions |          |
|------------------|----------|
| 600 - 1200 mm    | 2 Pieces |
| 1201 - 2100 mm   | 3 Pieces |

## Guide Unit L/R

|  | Article Code | Article        | Qty |
|--|--------------|----------------|-----|
|  | V.4752.0X02  | Guide Unit L/R | 3   |

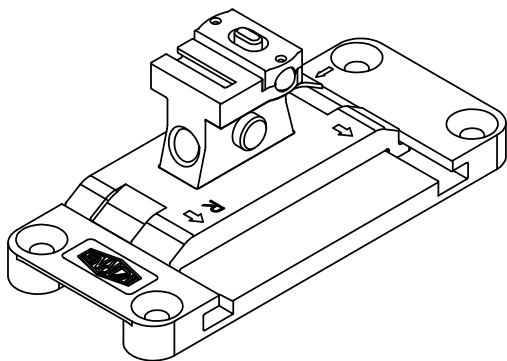

| Width Dimensions |          |
|------------------|----------|
| 600 - 1200 mm    | 2 Pieces |
| 1201 - 2100 mm   | 3 Pieces |

## Center Locking L/R

| Article Code | Article            | Qty |
|--------------|--------------------|-----|
| V.4753.0X02  | Center Locking L/R | 3   |

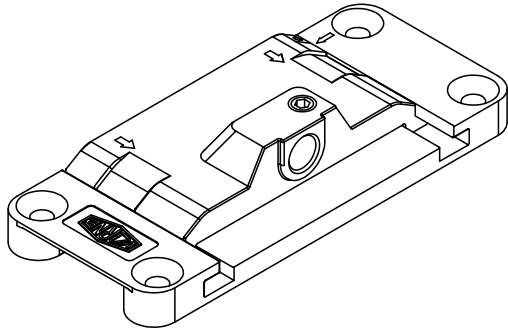

| Length Dimensions |  |
|-------------------|---|
| < 1200mm          | 2 Pieces  |
| 1201mm - 1700mm   | 3 Pieces  |
| 1701mm - 2400mm   | 4 Pieces  |

## Locking Pin

| Article Code  | Article     | Qty |
|---------------|-------------|-----|
| A V.4754.0140 | Locking Pin | 10  |
| B V.4754.0145 | Locking Pin | 10  |
| C V.4754.0150 | Locking Pin | 10  |

| Profile Name         | Looking Cam |
|----------------------|-------------|
| Adopen               | 43mm        |
| Aluplast Smart Slide | 48mm        |
| Asaş Inowa           | 43mm        |
| Decco                | 48mm        |
| Deceuninck           | 38mm        |
| Gealan SMOOVIO       | 48mm        |
| Pimapen              | 38mm        |
| Rehau Inowa          | 43mm        |
| Rehau Synego         | 48mm        |
| Salamander           | 48mm        |
| Schönlne             | 43mm        |
| Schuco Inowa         | 43mm        |
| Tecnocom             | 43mm        |
| Veka E-Slide         | 43mm        |
| Winsa                | 38mm        |

A

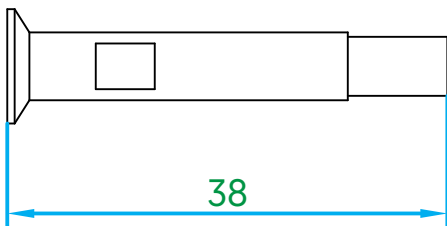

B

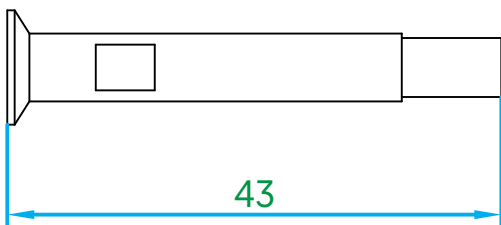

C

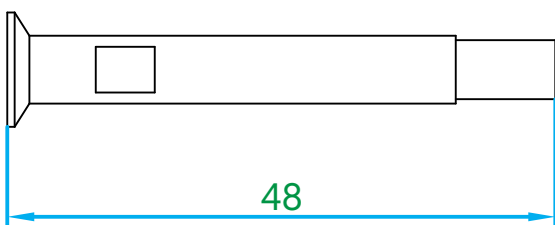

## Center Locking Striker

| Article Code | Article                | Qty |
|--------------|------------------------|-----|
| V.4762.0102  | Center Locking Striker | 3   |

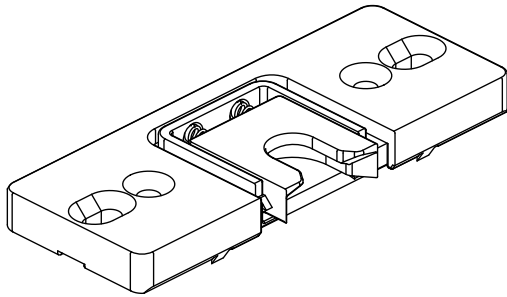

## Striker



|   | Article Code | Article             | Qty |   |
|---|--------------|---------------------|-----|---|
| A | V.4761.0102  | Striker             | 10  | 2 |
| B | V.4761.0202  | Ventilation Striker | 10  | 2 |

A

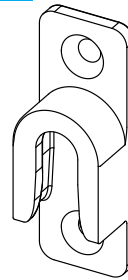

B

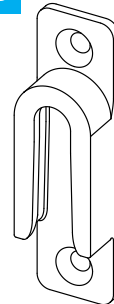

## Center Locking Striker Cover Cap

| Article Code | Article                          | Colour                         | Qty |
|--------------|----------------------------------|--------------------------------|-----|
| V.4762.0007  | Center Locking Striker Cover Cap | White<br>RAL 9016              | 10  |
| V.4762.0010  | Center Locking Striker Cover Cap | Silver                         | 10  |
| V.4762.0016  | Center Locking Striker Cover Cap | Black<br>RAL 9005              | 10  |
| V.4762.0032  | Center Locking Striker Cover Cap | Anthracite<br>Grey<br>RAL 7016 | 10  |

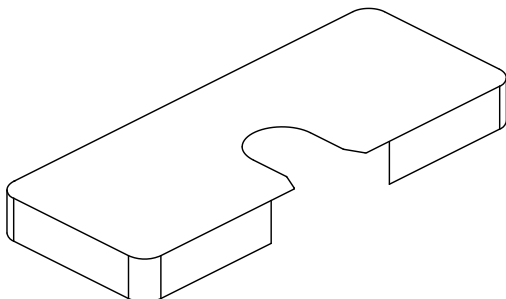

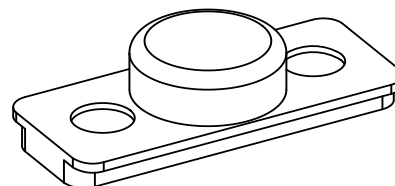

## Stopper

| Article Code | Article | Colour            | Qty |
|--------------|---------|-------------------|-----|
| V.4764.0116  | Stopper | Black<br>RAL 9005 | 10  |



# Gear

## Variable / 30-35-40 Axis

| 'X'<br>[Axis] | Article Code<br>SC  | Article | Qty | 'KA'<br>[mm] | 'A'<br>[mm] | 'B'<br>[mm] | 'C'<br>[mm] |  |  |
|---------------|--|---------|-----|--------------|-------------|-------------|-------------|---|--|
| 30 mm         | V.0228.0102  | Gear    | 10  | 450 - 700    | 400         | -           | -           | -   | -  |
|               | V.0236.0202  | Gear    | 10  | 700 - 1200   | 900         | 111         | -           | 1   | 3  |
|               | V.0236.0402  | Gear    | 10  | 1200 - 1700  | 1400        | 111         | -           | 1   | 6  |
|               | V.0236.0502  | Gear    | 10  | 1700 - 2200  | 1900        | 350         | 350         | 2   | 8  |
|               | V.0236.0802  | Gear    | 10  | 1900 - 2400  | 2150        | 350         | 350         | 2   | 10   |
| 35 mm         | V.0218.0102  | Gear    | 10  | 450 - 700    | 400         | -           | -           | -   | -  |
|               | V.0238.0202  | Gear    | 10  | 700 - 1200   | 900         | 111         | -           | 1   | 3  |
|               | V.0238.0402  | Gear    | 10  | 1200 - 1700  | 1400        | 111         | -           | 1   | 6  |
|               | V.0238.0502  | Gear    | 10  | 1700 - 2200  | 1900        | 350         | 350         | 2   | 8  |
|               | V.0238.0802  | Gear    | 10  | 1900 - 2400  | 2150        | 350         | 350         | 2   | 10   |
| 40 mm         | V.0233.0102  | Gear    | 10  | 450 - 700    | 400         | -           | -           | -   | -  |
|               | V.0240.0202  | Gear    | 10  | 700 - 1200   | 900         | 111         | -           | 1   | 3  |
|               | V.0240.0402  | Gear    | 10  | 1200 - 1700  | 1400        | 111         | -           | 1   | 6  |
|               | V.0240.0502  | Gear    | 10  | 1700 - 2200  | 1900        | 350         | 350         | 2   | 8  |
|               | V.0240.0802  | Gear    | 10  | 1900 - 2400  | 2150        | 350         | 350         | 2   | 10   |

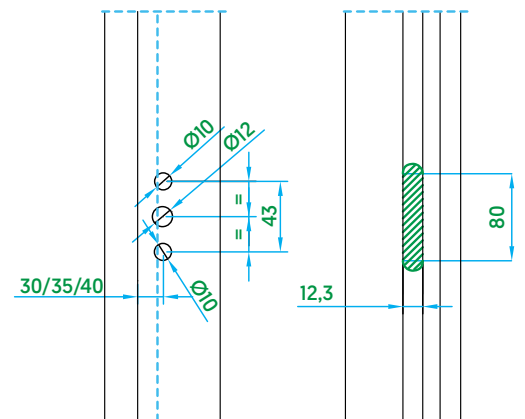
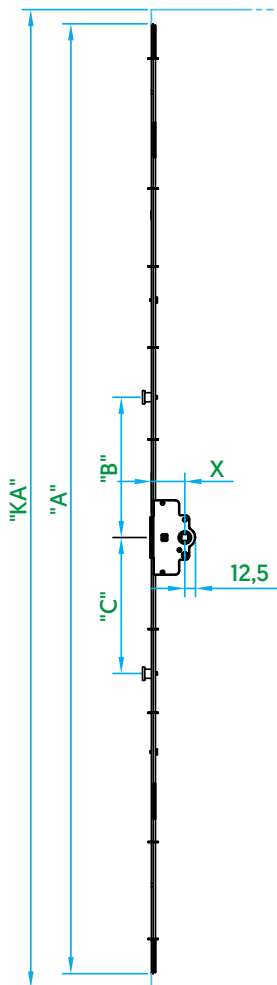

| Profile Name         | Gear Axis |
|----------------------|-----------|
| Adopen               | 40mm      |
| Aluplast Smart Slide | 35mm      |
| Asaş Inowa           | 40mm      |
| Decco                | 35mm      |
| Deceuninck           | 40mm      |
| Gealan SMOOVIO       | 35mm      |
| Pimapen              | 40mm      |
| Rehau Inowa          | 40mm      |
| Rehau Synego         | 35/40mm   |
| Salamander           | 35mm      |
| Schönline            | 40mm      |
| Schuco Inowa         | 40mm      |
| Tecnocom             | 40mm      |
| Veka E-Slide         | 40mm      |
| Winsa                | 40mm      |



# Locked Door Gear

## Variable / 30-35-40 Axis



|          | Article Code<br>SC  | Article          | Qty | 'KA'<br>(mm) | 'A'<br>(mm) | 'B'<br>(mm) | 'C'<br>(mm) |  |  |
|----------|--|------------------|-----|--------------|-------------|-------------|-------------|--|---|
| 30<br>mm | V6106.0402   | Locked Door Gear | 10  | 1200 - 1700  | 1400        | 111         | -           | 1  | 5   |
|          | V6106.0502   | Locked Door Gear | 10  | 1700 - 2200  | 1900        | 350         | 350         | 2  | 8   |
|          | V6106.0802   | Locked Door Gear | 10  | 1900 - 2400  | 2150        | 350         | 350         | 2  | 10  |
| 35<br>mm | V6107.0402   | Locked Door Gear | 10  | 1200 - 1700  | 1400        | 111         | -           | 1  | 5   |
|          | V6107.0502   | Locked Door Gear | 10  | 1700 - 2200  | 1900        | 350         | 350         | 2  | 8   |
|          | V6107.0802   | Locked Door Gear | 10  | 1900 - 2400  | 2150        | 350         | 350         | 2  | 10  |
| 40<br>mm | V6108.0402   | Locked Door Gear | 10  | 1200 - 1700  | 1400        | 111         | -           | 1  | 5   |
|          | V6108.0502   | Locked Door Gear | 10  | 1700 - 2200  | 1900        | 350         | 350         | 2  | 8   |
|          | V6108.0802   | Locked Door Gear | 10  | 1900 - 2400  | 2150        | 350         | 350         | 2  | 10  |

| Profile Name         | Gear Axis |
|----------------------|-----------|
| Adopen               | 40mm      |
| Aluplast Smart Slide | 35mm      |
| Asaş Inowa           | 40mm      |
| Decco                | 35mm      |
| Deceuninck           | 40mm      |
| Gealan SMOOVIO       | 35mm      |
| Pimapen              | 40mm      |
| Rehau Inowa          | 40mm      |
| Rehau Synego         | 35/40mm   |
| Salamander           | 35mm      |
| Schönline            | 40mm      |
| Schuco Inowa         | 40mm      |
| Tecnocom             | 40mm      |
| Veka E-Slide         | 40mm      |
| Winsa                | 40mm      |

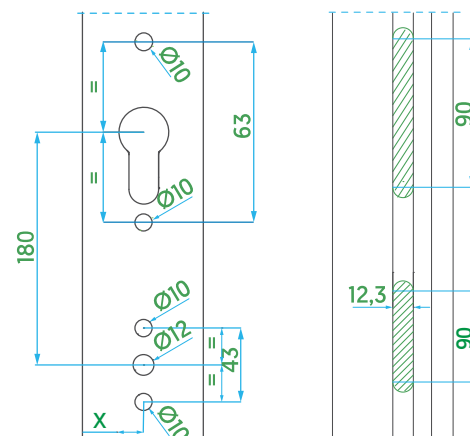
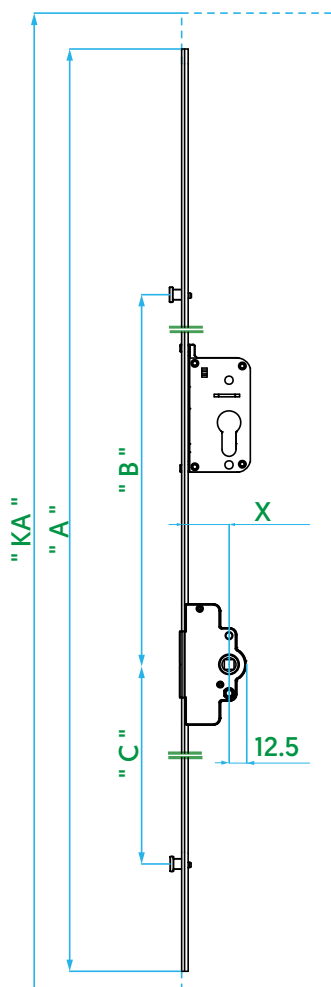



# Corner Slider

## Standart & Security Cam (Single Cam)

|  | Article Code | Article                            | Qty |   |   |   |
|--|--------------|------------------------------------|-----|---|---|---|
|  | V.0601.0102  | Corner Slider / 150 RC1 x 130 (mm) | 100 | 1 | - | 4 |
|  | V.0601.0202  | Corner Slider / 150 SC1 x 130 (mm) | 100 | - | 1 | 4 |

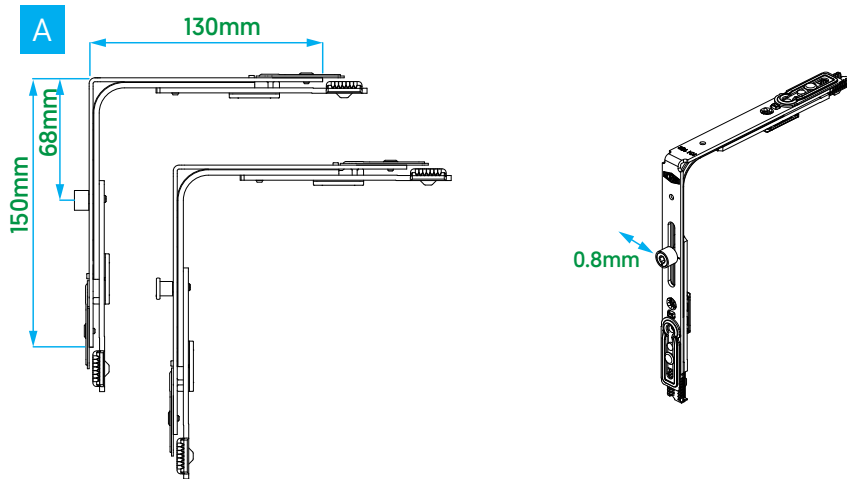

# Connection Gear





|          | Article Code<br>RC | Article         | Qty | 'KA'<br>[mm] | 'A'<br>[mm] | 'B'<br>[mm] | 'C'<br>[mm] |   |    |
|----------|--------------------|-----------------|-----|--------------|-------------|-------------|-------------|---|----|
| Vertical | V.0207.0102        | Connection Gear | 10  | 450 - 700    | 400         | -           | -           | - | -  |
|          | V.0213.0202        | Connection Gear | 10  | 700 - 1200   | 900         | -           | -           | - | 3  |
|          | V.0213.0402        | Connection Gear | 10  | 1200 - 1700  | 1400        | 111         | -           | 1 | 6  |
|          | V.0213.0502        | Connection Gear | 10  | 1700 - 2200  | 1900        | 350         | 350         | 2 | 8  |
|          | V.0213.0802        | Connection Gear | 10  | 1900 - 2400  | 2150        | 350         | 350         | 2 | 10 |

|            | Article Code<br>RC | Article         | Qty | 'KA'<br>[mm] | 'A'<br>[mm] | 'B'<br>[mm] | 'C'<br>[mm] |   |   |
|------------|--------------------|-----------------|-----|--------------|-------------|-------------|-------------|---|---|
| Horizontal | V.0207.0102*       | Connection Gear | 10  | 600 - 960    | 400         | -           | -           | - | - |
|            | V.0213.0202        | Connection Gear | 10  | 961 - 1200   | 900         | -           | -           | - | 3 |
|            | V.0213.1202        | Connection Gear | 10  | 1201 - 1460  | 900         | -           | -           | 1 | 3 |
|            | V.0213.0402        | Connection Gear | 10  | 1461 - 1960  | 1400        | 111         | -           | 1 | 6 |
|            | V.0213.0502        | Connection Gear | 10  | 1961 - 2100  | 1900        | 350         | 350         | 2 | 8 |

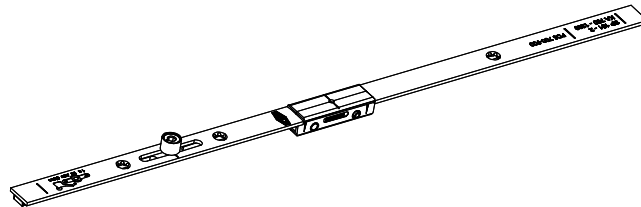
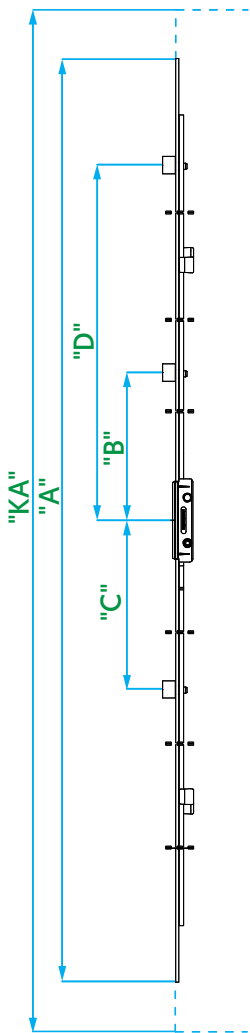
\* Short corner should be used for 600mm - 760mm.



# Extension Part

|  | Article Code | Article        | Qty | 'A'<br>(mm) | 'B'<br>(mm) |  |  |  |
|--|--------------|----------------|-----|-------------|-------------|---|---|---|
|  | V.1102.0102  | Extension Part | 10  | 82          | 150         | 1   | -   | 2   |
|  | V.1102.0402* | Extension Part | 10  | 82          | 200         | 1   | -   | 2   |
|  | V.1103.0402* | Extension Part | 10  | 82          | 200         | -   | 1   | 2   |

\* It is used on the vertical parts of the sash when the locking distances are required to be max 700 mm. The cutting of the gears should be done by considering the 200 mm extension part size.

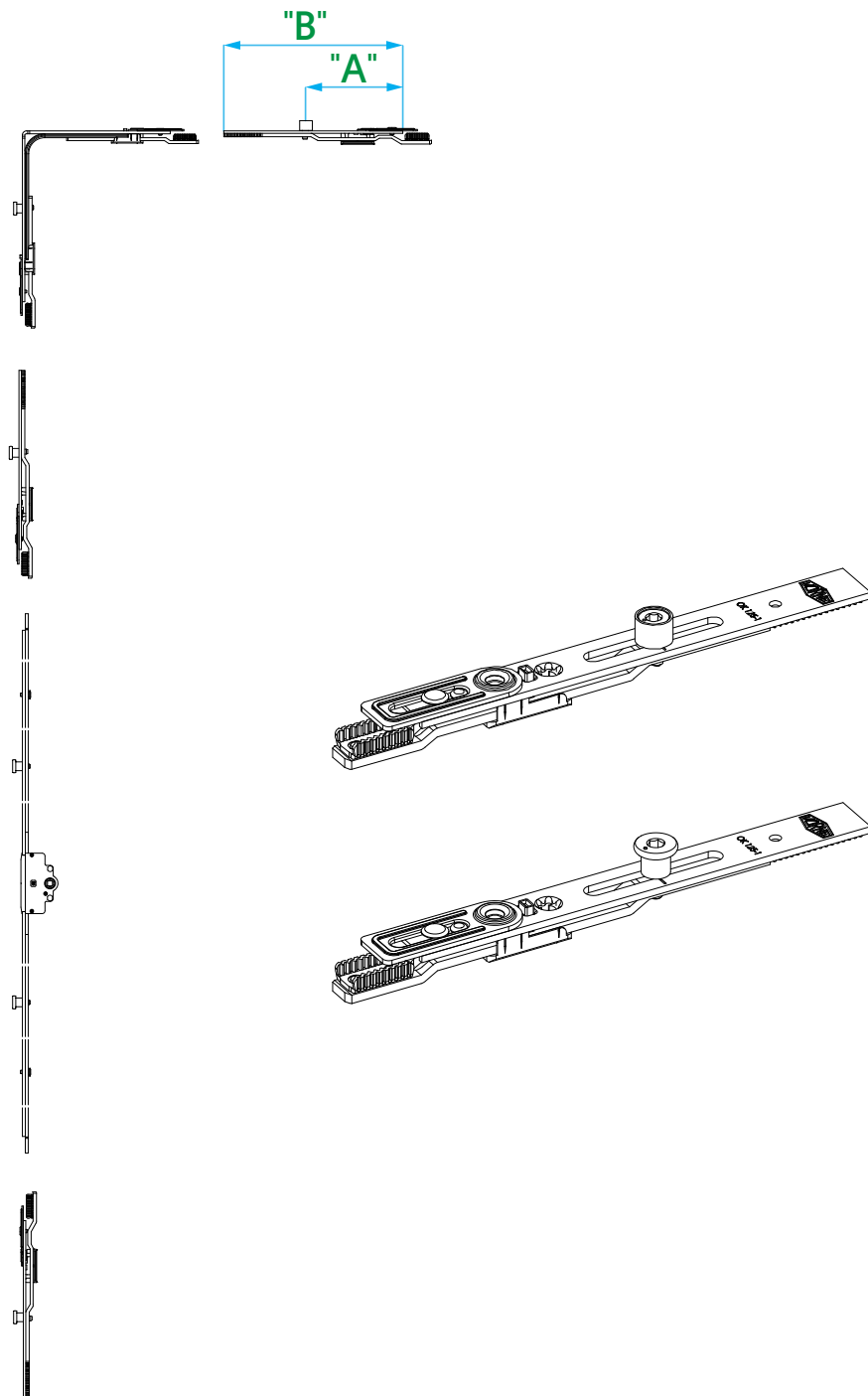

# Handle



| Article Code | Article | Colour                     | Qty |
|--------------|---------|----------------------------|-----|
| T.4601.0307  | Handle  | White / RAL 9016           | 1   |
| T.4601.0310  | Handle  | Silver                     | 1   |
| T.4601.0316  | Handle  | Black / RAL 9005           | 1   |
| T.4601.0332  | Handle  | Anthracite Grey / RAL 7016 | 1   |

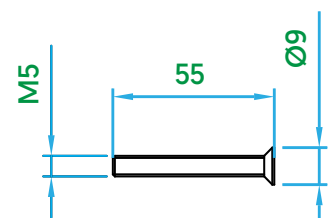
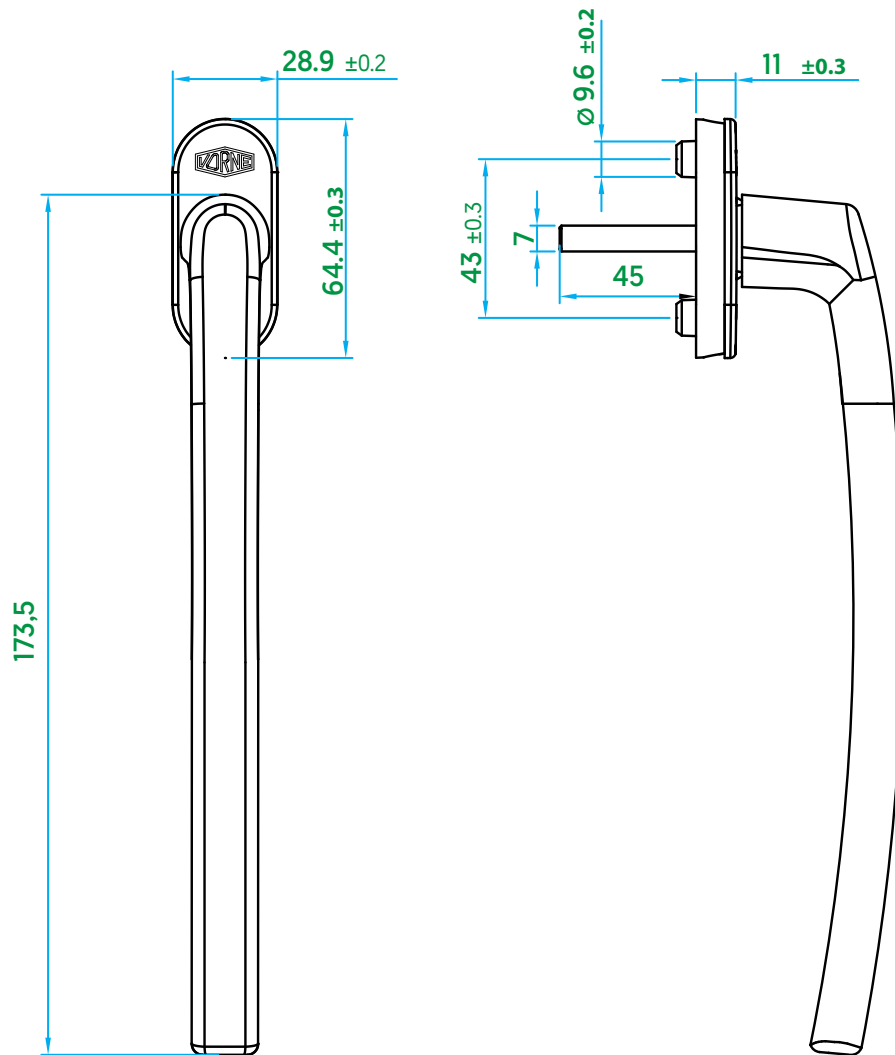

# Double Side Handle

|             |                    |                            |   |  |
|-------------|--------------------|----------------------------|---|--|
|             |                    |                            |   |  |
| T.4603.0307 | Double Side Handle | White / RAL 9016           | 1 |  |
| T.4603.0310 | Double Side Handle | Silver                     | 1 |  |
| T.4603.0316 | Double Side Handle | Black / RAL 9005           | 1 |  |
| T.4603.0332 | Double Side Handle | Anthracite Grey / RAL 7016 | 1 |  |

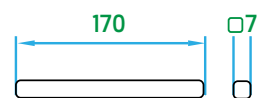
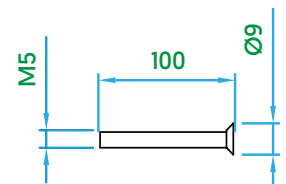
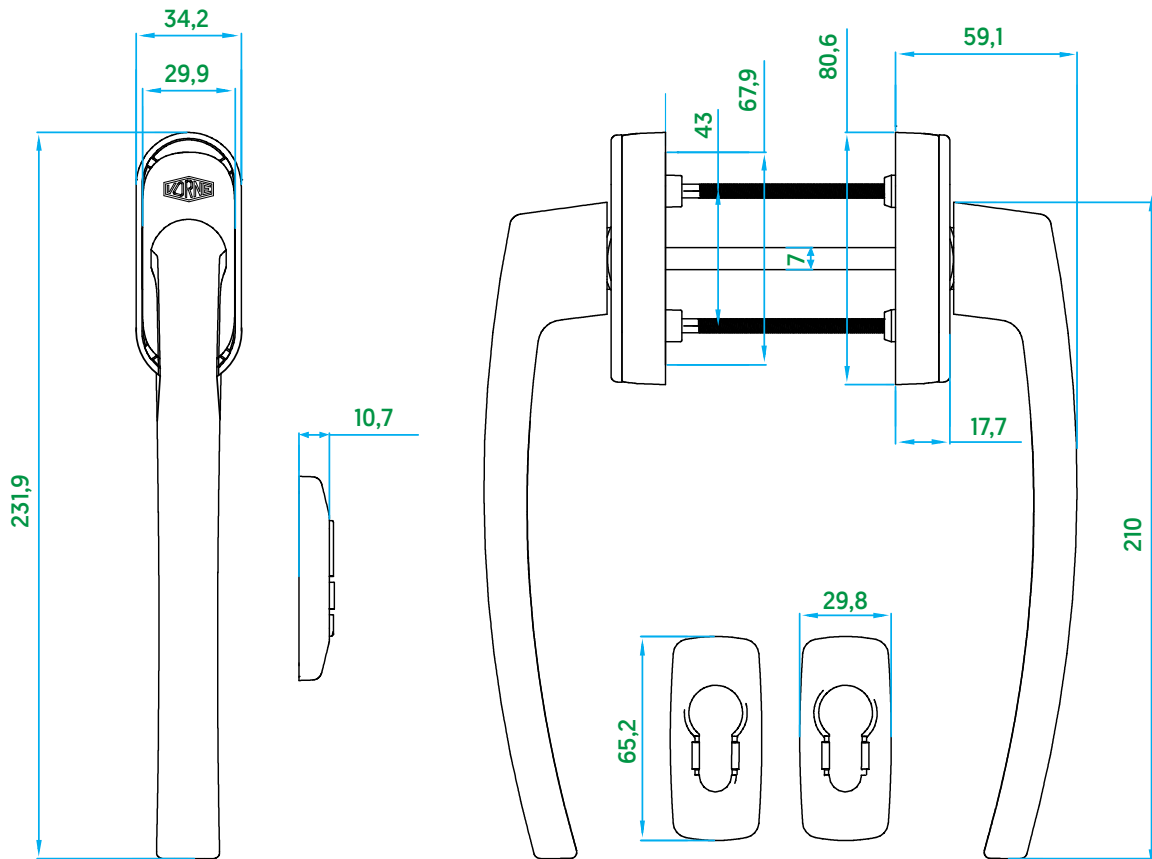

| Article Code | Article   |
|--------------|-----------|
| V.4765.0114  | Bogie Jig |

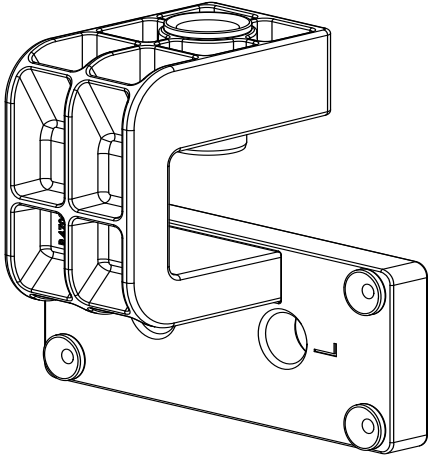

| Article Code | Article     |
|--------------|-------------|
| V.4766.0102  | Striker Jig |

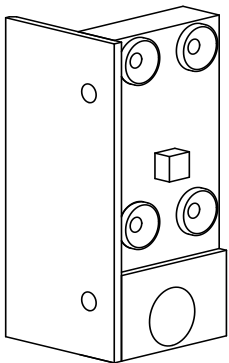

| Article Code | Article                    | Profile to be used                                     |
|--------------|----------------------------|--|
| V.4767.0114  | Center Locking Striker Jig | Adopen / Asaş Inowa / Egepen                           |
| V.4767.0214  | Center Locking Striker Jig | Gealan SMOOVIO / Salamander / Schönline / Veka E Slide |
| V.4767.0314  | Center Locking Striker Jig | Rehu Synego  |
| V.4767.0414  | Center Locking Striker Jig | Aluplast Smart Slide                                   |
| V.4767.0514  | Center Locking Striker Jig | Decco  |
| V.4767.0614  | Center Locking Striker Jig | Tecnocom   |
| V.4767.0714  | Center Locking Striker Jig | Vekamove 76  |

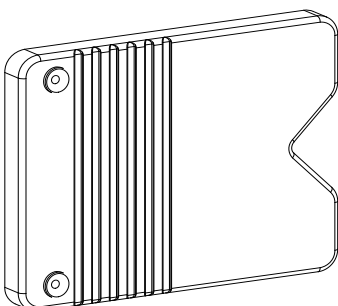

# ■ Handle Positions

Locking Position

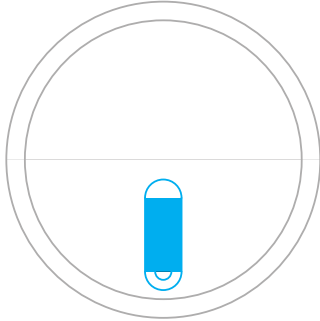

Sliding Position

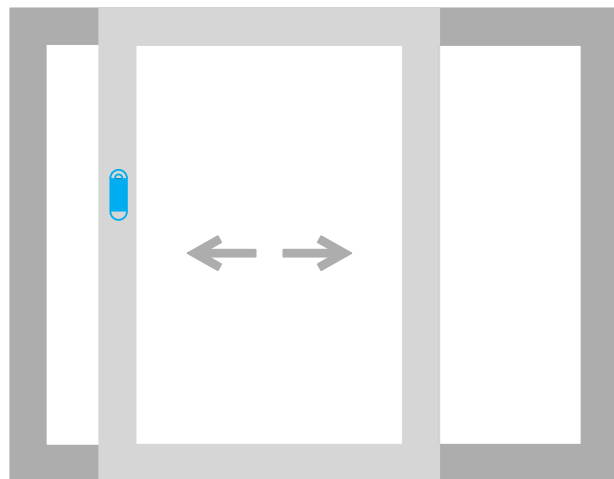
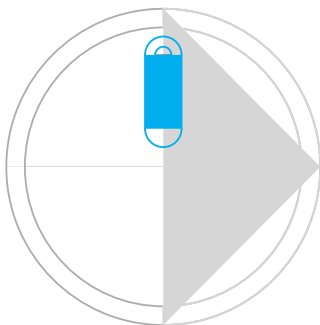

Ventilation Position

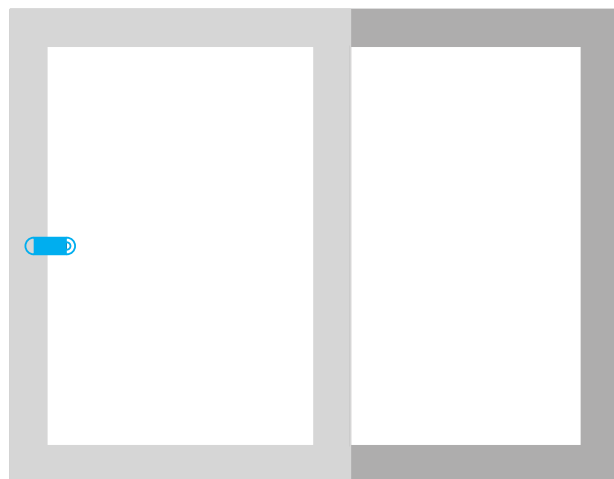
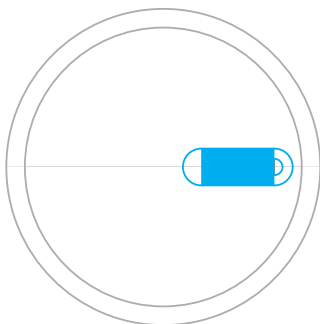

# Product Assembly

## 1-Bogie Unit Assembly



1-a

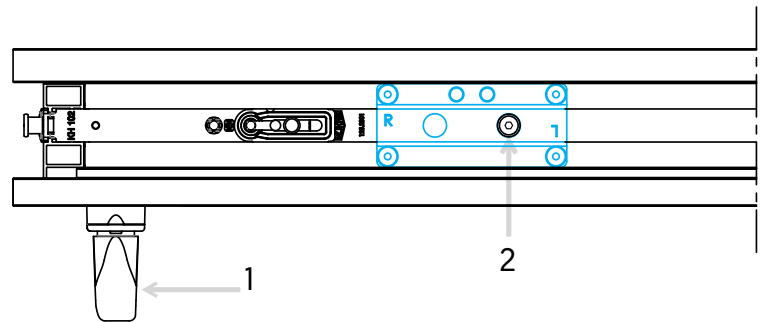
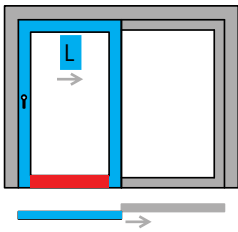

**\*When the handle is in the locking position, the slot 'L' of the jig is placed on the cam.**

1-b

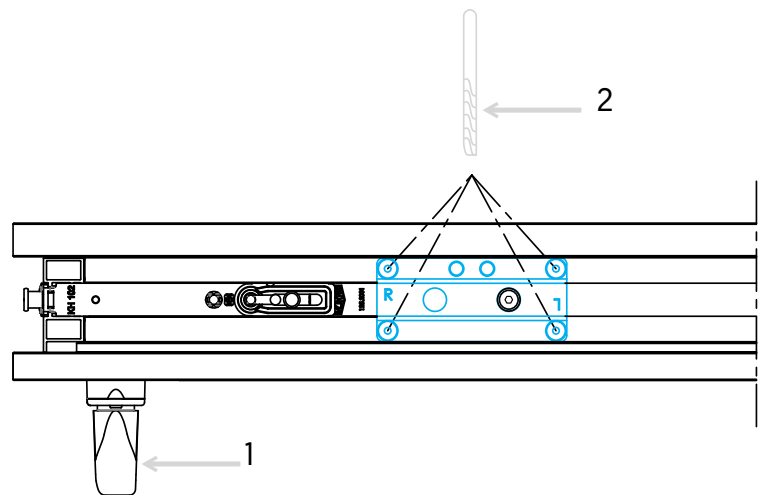
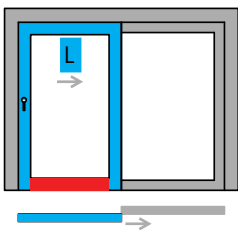

**\*Use Ø3 drill for drilled holes.**

1-c

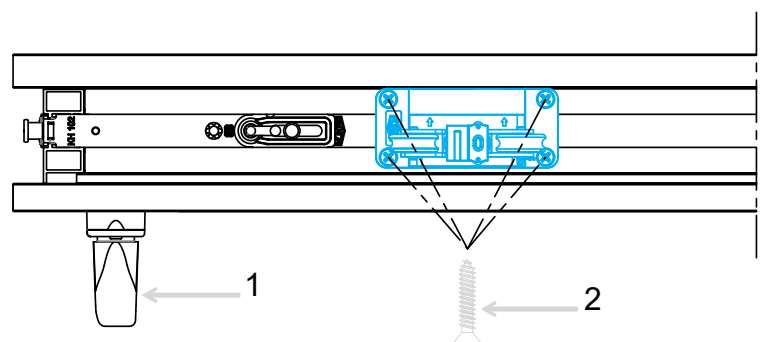
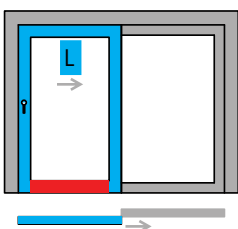

**\*Use 3,9x... screws for bogie unit.**

### Attention!

**\*Before assembly the handle need to be correct position.**

Mounting and drilling are need to apply with **"locking"** position of handle.

**\*L system is used as an example in the application. For R system application, use the R parts of the products and jig.**

# Product Assembly

## 2- Guide Unit Assembly

1-a

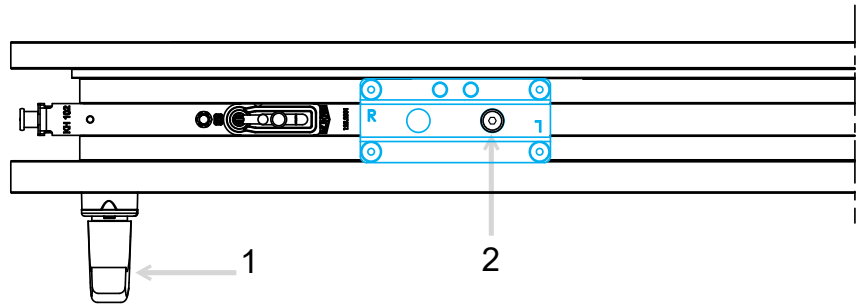
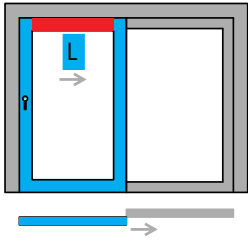

\*When the handle is in the locking position, the slot 'L' of the jig is placed on the cam.

1-b

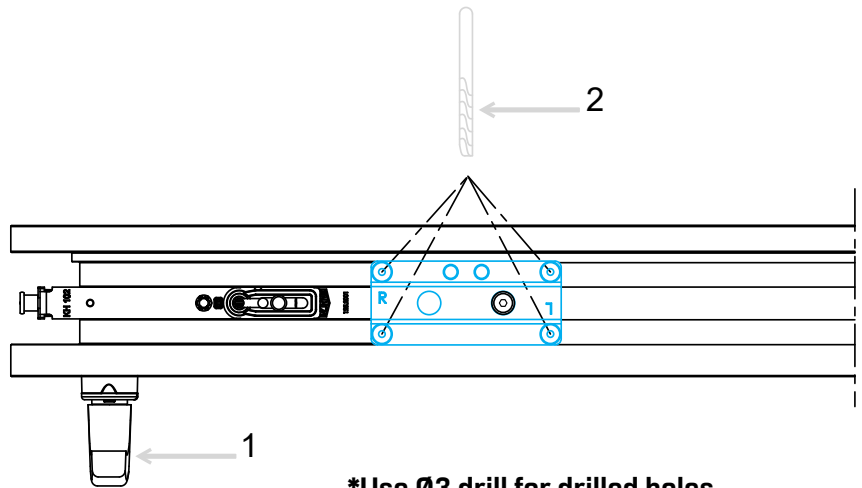
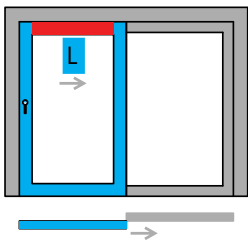

\*Use Ø3 drill for drilled holes.

1-c

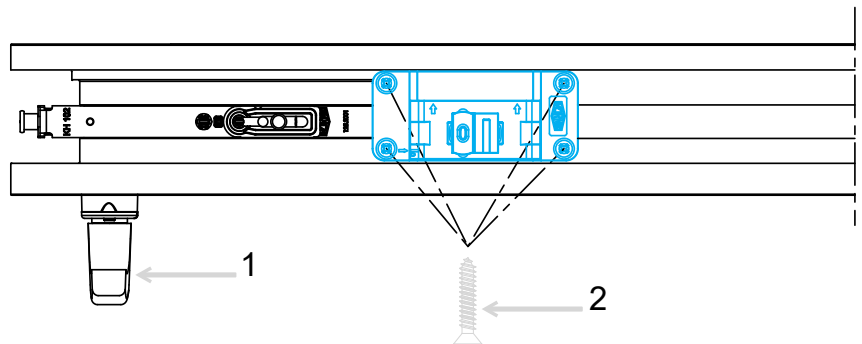
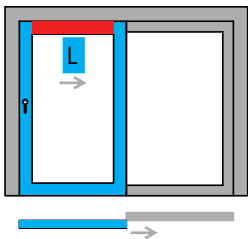

\*Use 3,9x... screws for guide unit.

### Attention!

\*Before assembly the handle need to be correct position.

Mounting and drilling are need to apply with **"locking"** position of handle.

\*L system is used as an example in the application. For R system application, use the R parts of the products and jig.

# Product Assembly

## 3- Center Locking Assembly



1-a

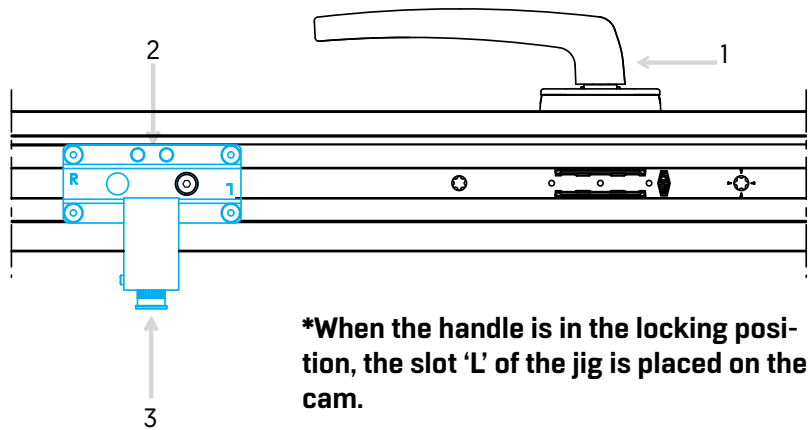
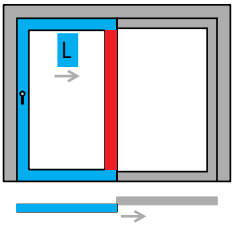

1-b

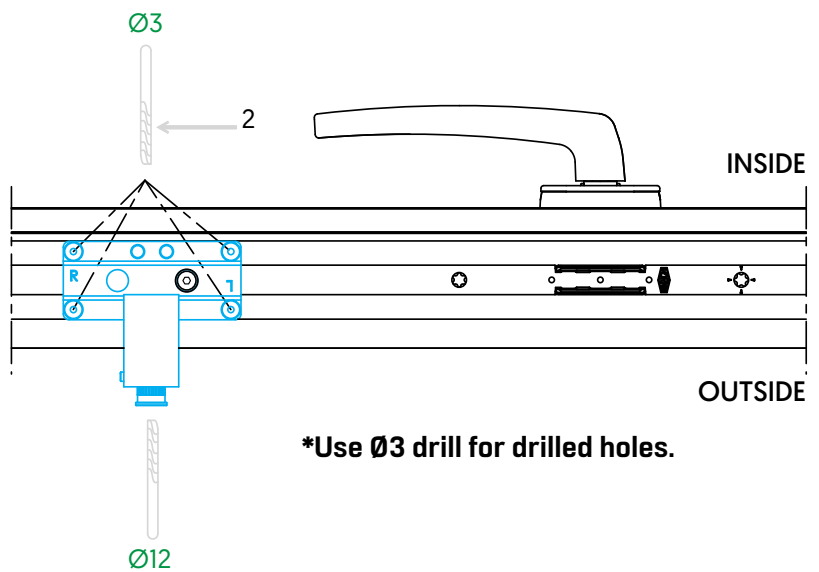
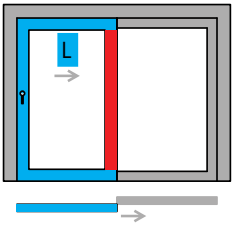

1-c

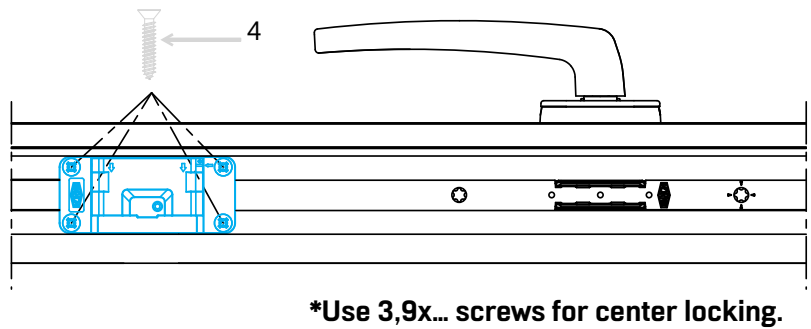
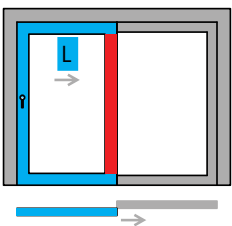

1-d

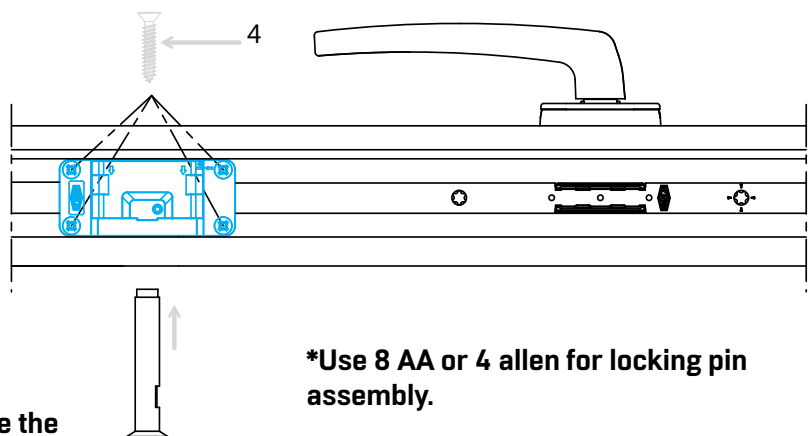
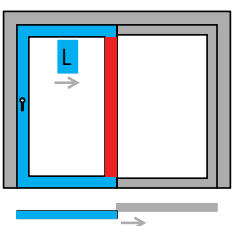

### Attention!

\*L system is used as an example in the application. For R system application, use the R parts of the products and jig.

## Striker Positions

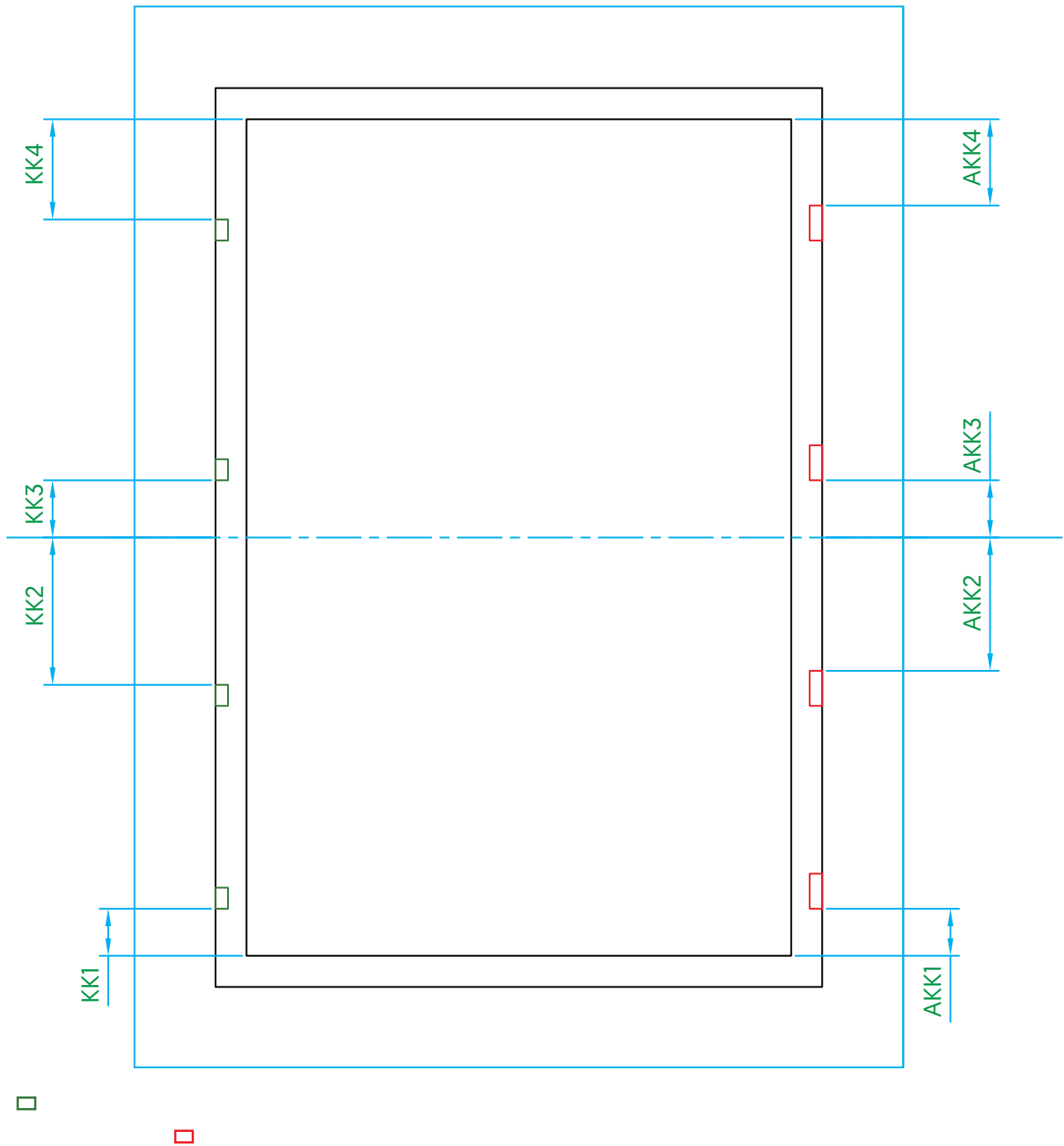

|  | KA / mm   | AKK1 | AKK2 | AKK3 | AKK4 | KK1 | KK2 | KK3 | KK4 |
|--|-----------|------|------|------|------|-----|-----|-----|-----|
|  | 450-700   | 104  | -    | -    | 61   | 58  | -   | -   | 58  |
|  | 700-1200  | 104  | -    | 108  | 61   | 58  | -   | -   | 58  |
|  | 1200-1700 | 104  | -    | 108  | 61   | 58  | -   | 63  | 58  |
|  | 1700-2200 | 104  | 304  | 347  | 61   | 58  | 302 | 302 | 58  |
|  | 1900-2400 | 104  | 304  | 347  | 61   | 58  | 302 | 302 | 58  |

# Striker Jigs Application

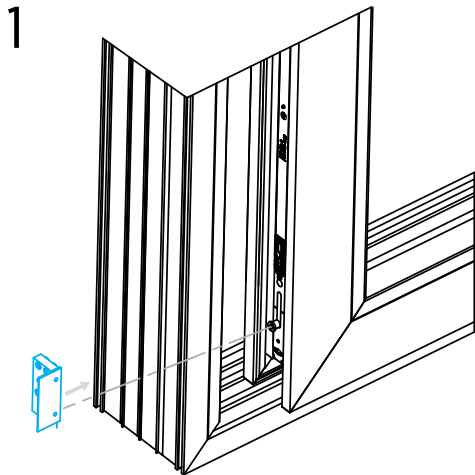

Striker jigs placed on the cam when sash is in sliding position.

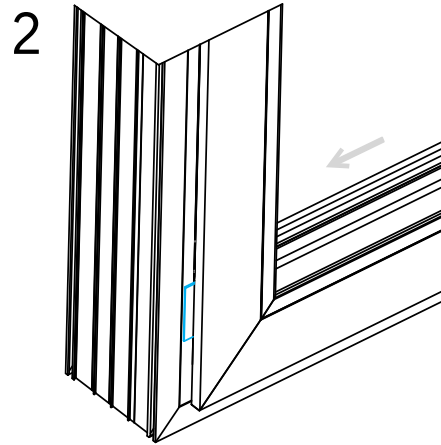

Bring the sash to the closing position.

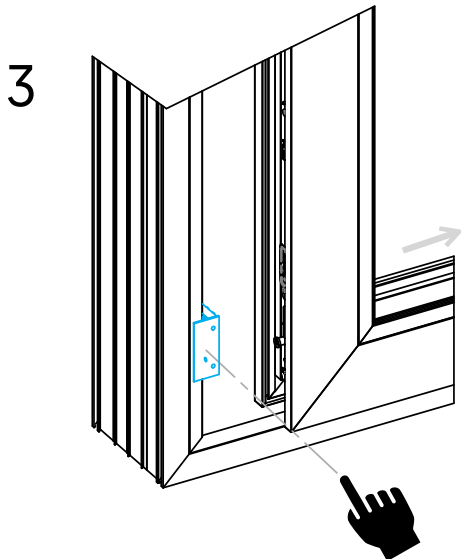

Before open the sash; hold and fixed the jig.

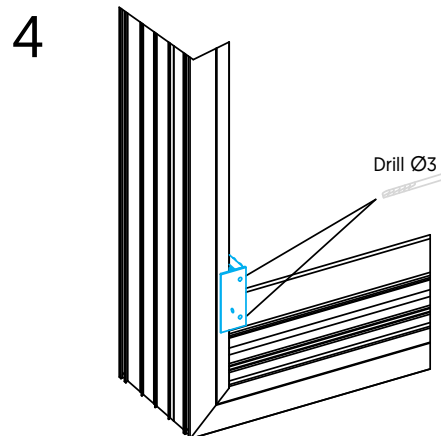

Use Ø3 drill for drilled strikers.

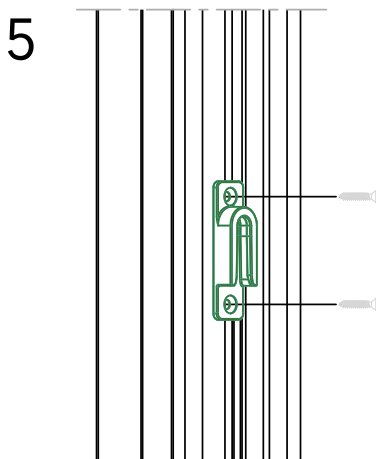

Screw on the striker to the drilled holes.

# Striker Assembly

V.4761.0102  
Striker

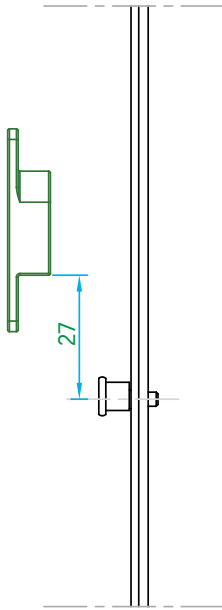

V.4761.0202  
Ventilation Striker

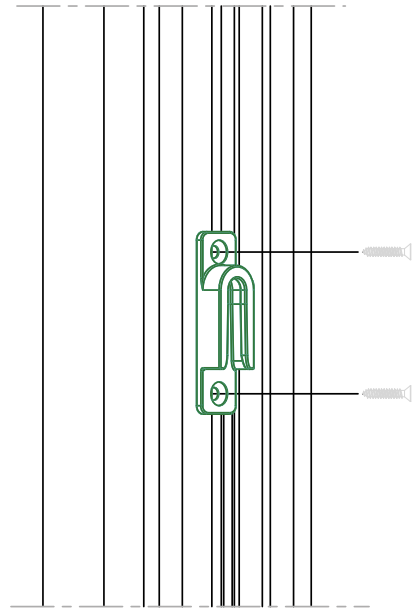
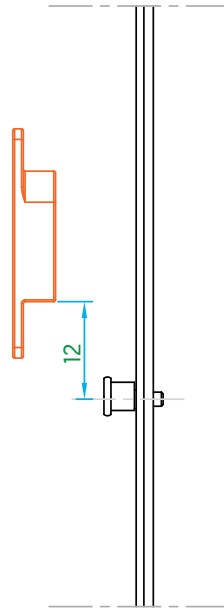

Handle Sliding Position

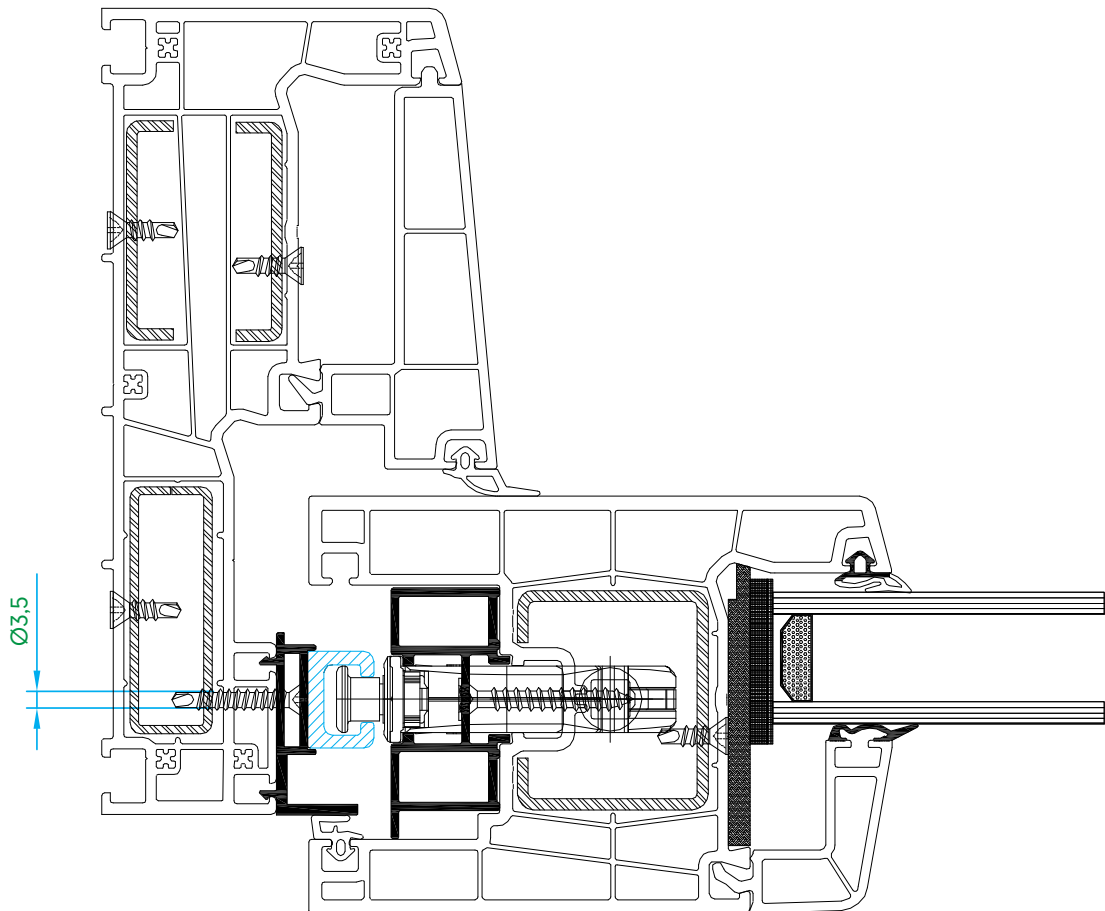

# Center Locking Assembly

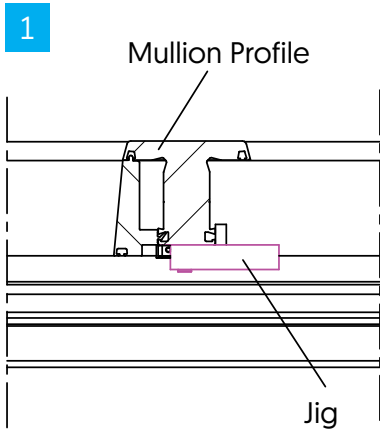

\*Jig cam assemble to mullion.

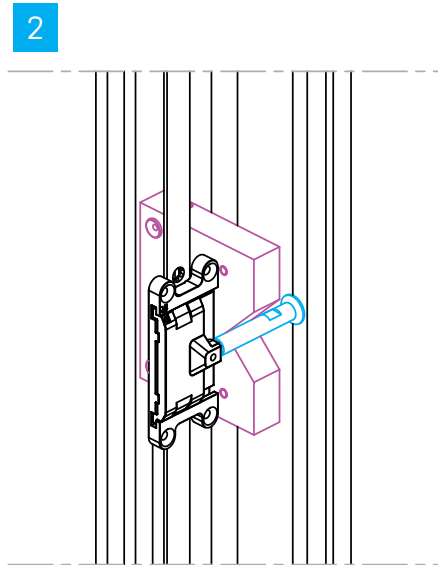

\*Locate the locking cam to the "V" housing on the jig and assemble.

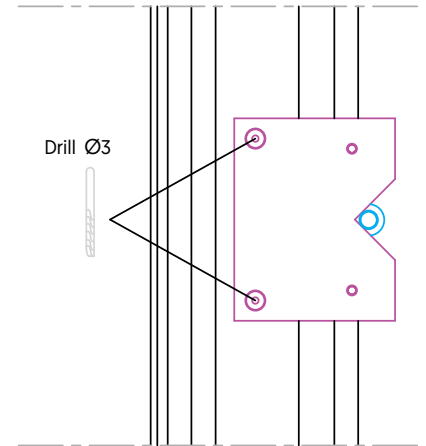

\*Hold and fix the jig with using Ø3 drill.

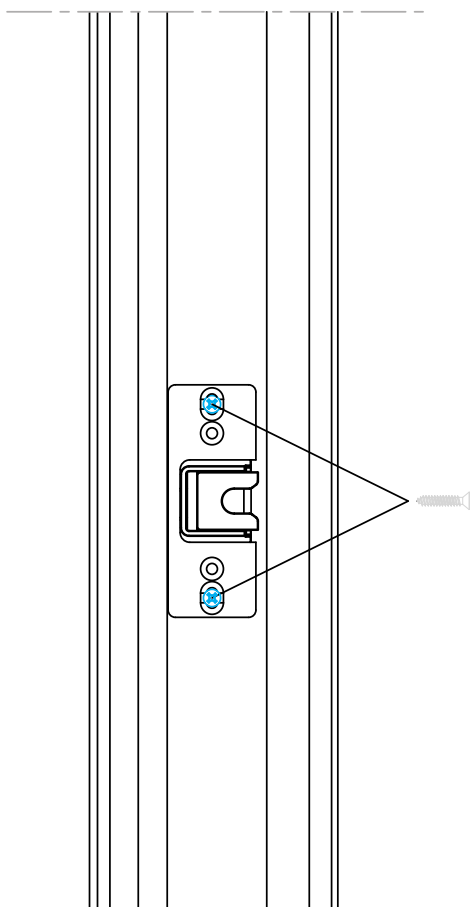

Check and fixed by screws.

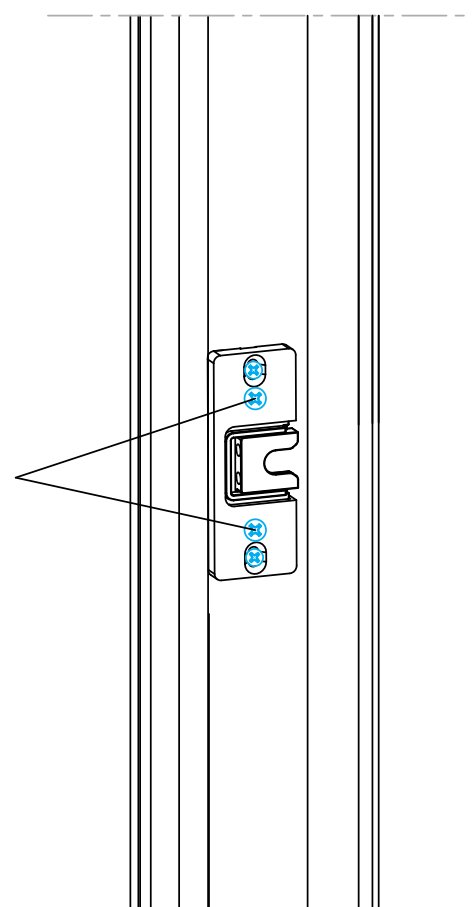

## Attention!

\*Before assembly the handle need to be correct position.

\*Mounting and drilling are need to apply with "sliding" position of handle.

## Sash Assembly

### **Attention!**

An unsecured sash can pose a danger of death.

If not securely fixed to the frame, the sash may fall during installation.

Perform the application with at least two people to prevent the sash from falling.

1-) Placed to the bogies on the rail and bring to vertical position.

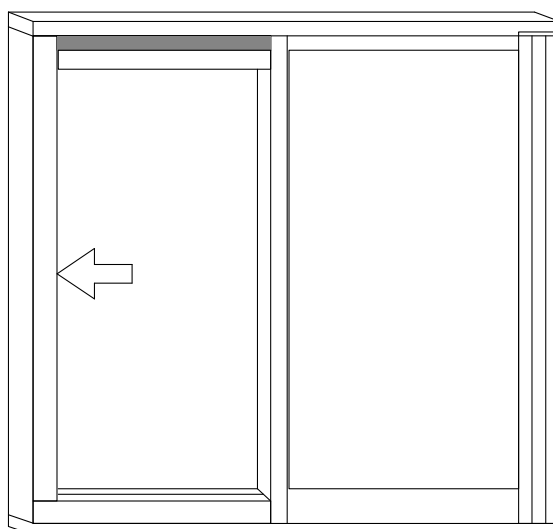
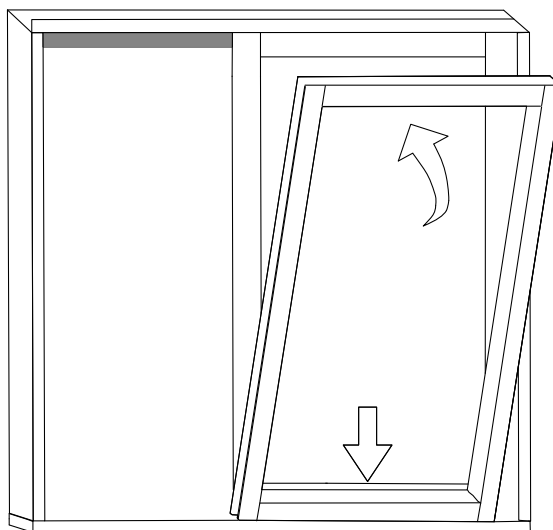

3-) Remain part of top rail screw to the frame. (Distance of screws must be max. 300mm).

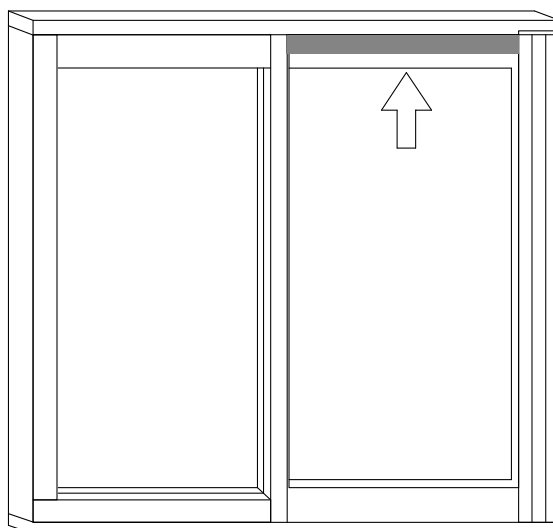

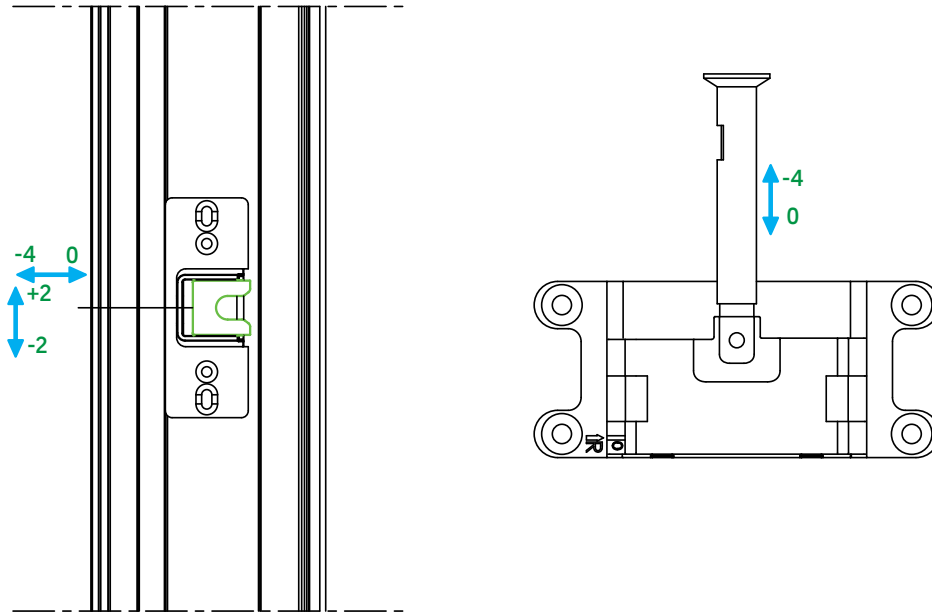

# Diagram

SRH: SRW = max. 2:1

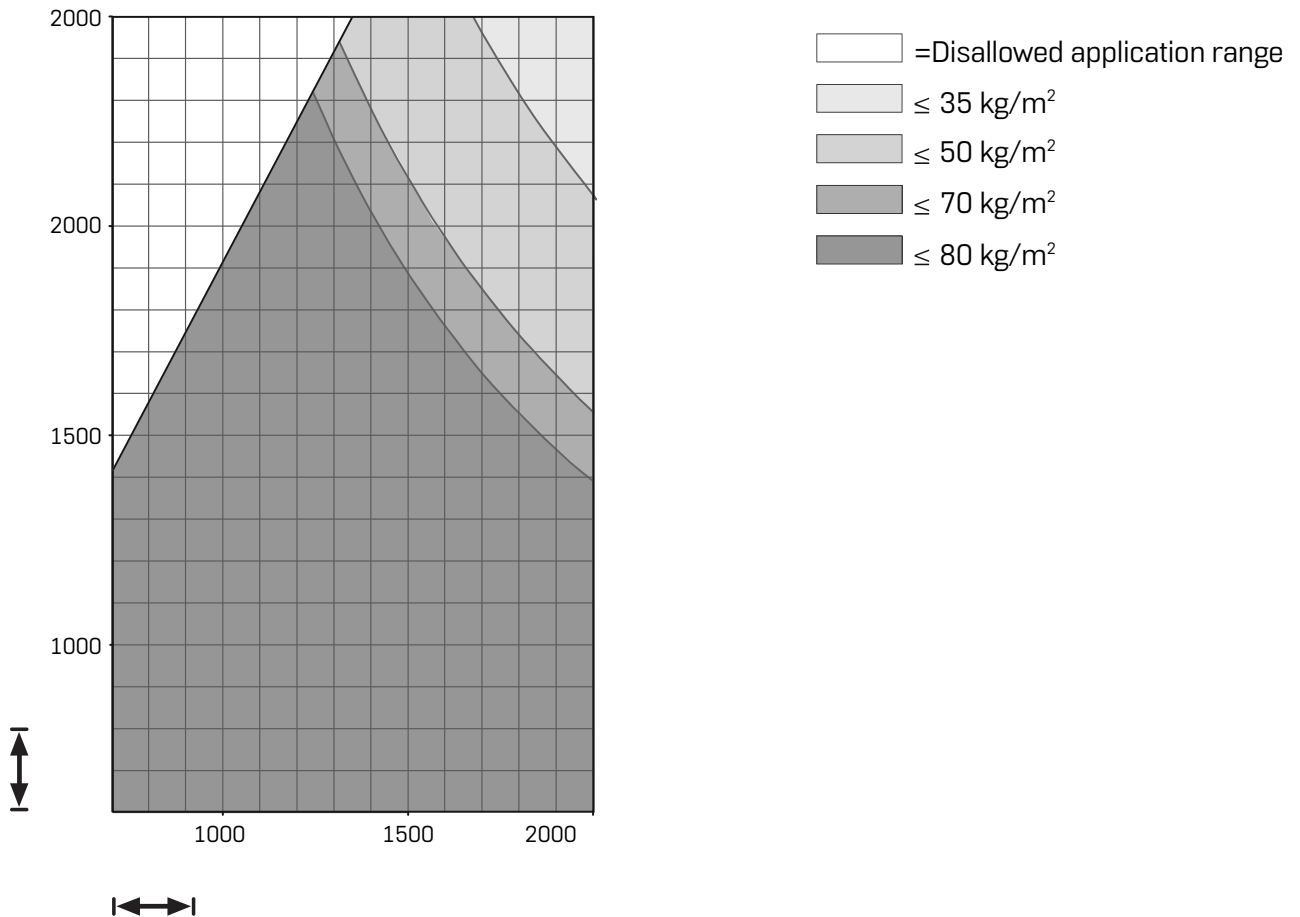



WINDOW & DOOR SYSTEMS